



6 Mary Barton Fields, Moss Side, Manchester, M14 4EQ

Online Video/Physical Viewings Available ...<https://youtu.be/vMZawdURTYw>

Jordan Fishwick are pleased to offer this well presented, deceptively spacious THREE BEDROOM townhouse, located just 7 minutes drive away from the heart of Manchester City Centre. The house is in a gated complex offering complete security, and there are communal gardens to the front which are very well maintained. The house briefly comprises of: entrance hall, living room with under-stair storage, kitchen diner offering access to the garden, wet room with storage cupboard. Upstairs over two additional floors there are two double bedrooms, one single and well proportioned bathroom. There is gated off street parking available to the rear of the property. No chain.

£210,000

Viewing arrangements

Viewing strictly by appointment through the agent
245 Deansgate, Manchester, M3 4EN 0161 833 9499 opt 3

ENTRANCE HALL

Fitted carpet. Radiator. Access to ground floor rooms.
Stairs leading to first floor.

LIVING ROOM

13'3" x 10'4"
Radiator. Fitted carpet. Window looking over the communal gardens. Under-stair storage. TV point. Ceiling light.

KITCHEN/DINER

13'5" x 8'6"
Range of wall and base units with complimentary worktops over. Fitted cooker with gas hob over and extractor fan above. Sink with mixer tap. Space for fridge/freezer and washing machine. Ceiling light. Radiator. Access to the rear garden.

WETROOM

Wetroom style shower. Low level W/C. Sink with vanity unit below. Storage cupboard.

MASTER BEDROOM

15'9" x 9'3"
Fitted carpet. Ceiling light. Radiator. Storage cupboard built in.

BEDROOM TWO

15'9" x 9'3"
Fitted carpet. Ceiling light. Radiator.

BEDROOM THREE

9'1" x 7'10"
Fitted carpet. Ceiling light. Radiator.

BATHROOM

Low level W/C. Bath with mixer shower over. Pedestal sink with taps above. Heated towel rail. Vinyl flooring.

EXTERNALLY

Indian stone paved patio to the rear with plant boxes. Space for a shed. Gated off road parking to the rear.

ADDITIONAL INFORMATION

Lease - 99 years from 2011

Ground rent - None payable.TBC

Service charges - £33.19 per month.

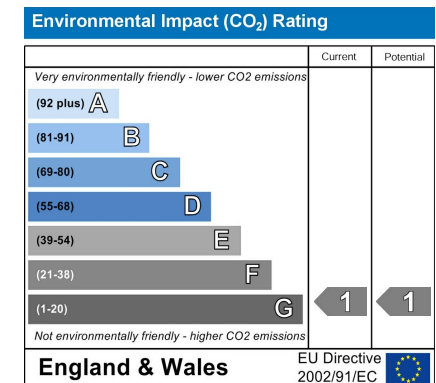
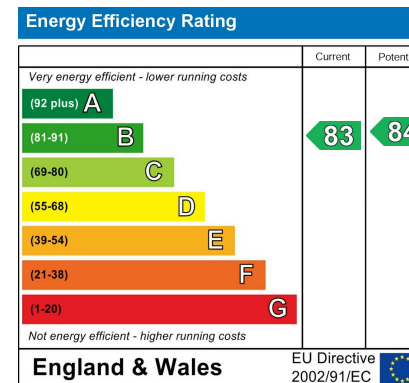



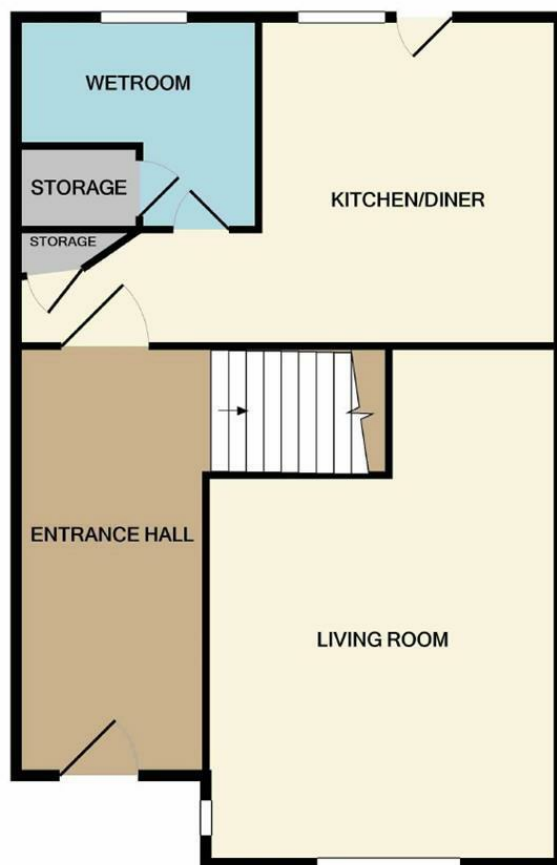

GROUND FLOOR



1ST FLOOR



2ND FLOOR

Measurements are approximate. Not to scale. Illustrative purposes only
Made with Metropix ©2021



These particulars are believed to be accurate but they are not guaranteed and do not form a contract. Neither Jordan Fishwick nor the vendor or lessor accept any responsibility in respect of these particulars, which are not intended to be statements or representations of fact and any intending purchaser or lessee must satisfy himself by inspection or otherwise as to the correctness of each of the statements contained in these particulars. Any floorplans on this brochure are for illustrative purposes only and are not necessarily to scale.

Offices at: Chorlton, Didsbury, Disley, Hale, Glossop, Macclesfield, Manchester Deansgate, Manchester Whitworth Street, New Mills, Sale, Wilmslow and Withington

245 Deansgate, Manchester, M3 4EN

0161 833 9499 opt 3

manchester@jordanfishwick.co.uk
www.jordanfishwick.co.uk

